

# FJ-UK3

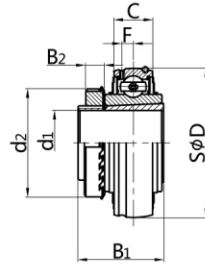

FJ-UK300+H

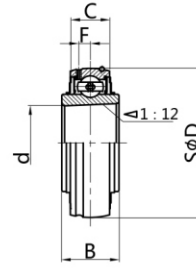

FJ-UK300

Bearing NO.	Dimensions ( mm / in. )									Dynamic load ratings(N)	Static load ratings(N)	Weight (kg)
	d1	d	D	B	C	B1	B2	d2	F			
FJ-UK305;H2305	20	25	62	26	20	35	8	38	5.4	22400	11500	0.36
305;HE2305	3/4	0.9843	2.4409	1.0236	0.7874	1.378	0.315	1.496	0.213			
FJ-UK306;H2306	25	30	72	29	23	38	8	45	6	26500	14900	0.56
306;HE2306	1	1.1811	2.8346	1.1417	0.9055	1.496	0.315	1.772	0.236			
306;HS2306	7/8											
FJ-UK307;H2307	30	35	80	33	25	43	9	52	6.8	33300	19100	0.72
307;HS2307	1-1/8	1.3780	3.1496	1.2992	0.9843	1.693	0.354	2.047	0.268			
FJ-UK308;H2308	35	40	90	34	27	46	10	58	7.4	40600	23700	0.99
308;HE2308	1-1/4	1.5748	3.5433	1.3386	1.0630	1.811	0.394	2.283	0.291			
308;HS2308	1-3/8											
FJ-UK309;H2309	40	45	100	37	30	50	11	65	8.4	48600	28900	1.29
309;HA2309	1-7/16	1.7717	3.9370	1.4567	1.1811	1.969	0.433	2.559	0.307			
309;HE2309	1-1/2											
309;HS2309	1-5/8											
FJ-UK310;H2310	45	50	110	41	32	55	12	70	9.2	62000	38000	1.71
310;HA2310	1-11/16	1.9685	4.3307	1.6142	1.2598	2.165	0.472	2.756	0.362			
310;HE2310	1-3/4											
310;HS2310	1-5/8											
FJ-UK311;H2311	50	55	120	44	34	59	12	75	9.9	71600	44600	2.08
311;HA2311	1-15/16	2.1654	4.7244	1.7323	1.3386	2.323	0.472	2.953	0.390			
311;HE2311	2											
311;HS2311	1-7/8											
FJ-UK312;H2312	55	60	130	47	36	62	13	80	10.5	81600	51800	2.88
312;HS2312	2-1/8	2.3622	5.1181	1.8504	1.4173	2.441	0.512	3.150	0.413			
FJ-UK313;H2313	60	65	140	49	38	65	14	85	11.5	93700	60400	3.10
313;HA2313	2-3/16	2.5591	5.5118	1.9291	1.4961	2.559	0.551	3.346	0.453			
313;HE2313	2-1/4											
313;HS2313	2-3/8											
FJ-UK315;H2315	65	75	160	55	42	73	15	98	12.8	112800	75700	4.76
315;HA2315	2-7/16	2.9528	6.2992	2.1654	1.6535	2.874	0.591	3.858	0.504			
315;HE2315	2-1/2											